

CAPITAL



Photo: kelvin@kelvindavies.co.uk

M/T ALTEREGO II M/T AMORE MIO II

BUILT: 2001-2002

CLASS: LRS

FLAG: LIBERIA



BUILDER: Daewoo Shipbuilding & Marine Engineering Co., Ltd. - S. Korea

VESSEL PARTICULARS

Type of vessel:	100A1 OIL TANKER, ESP, LI, LMC, UMS, IGS. DESCRIPTION NOTE: SHIP RIGHT (SCM,E)
Summer deadweight:	159,950 MT
Summer freeboard:	6.219 m
GRT / NRT:	83,616 / 48,679
LOA:	274 m
Beam:	48.04 m
Depth:	23.7 m
Keel to mast:	49.99 m



CARGO ARRANGEMENTS

Cargo / slop tanks:	12 / 2
Cargo capacity (98% ex slop tanks):	167,806.6 m ³
Slop tank capacity (98%):	3,282.8 m ³
Cargo tank coating:	Epoxy - deckhead to 2 m down & tank bottom to 1 m up
Heating arrangement:	Steam - aluminized steel heating coils Sch 80
COW:	Yes
Number of manifolds on each side:	3 x 400 mm
Distance bow to mid-point manifold:	134 m
Distance main deck to center manifold:	2,100 mm
Distance manifolds to ship's rail:	4,600 mm
Natural segregation with double valves:	3
Cranes/SWL:	2 x 15 T



CARGO PUMPS

Cargo pump type:	Centrifugal
Number of cargo pumps:	3
Capacity of cargo pumps:	3 x 3,700 m ³ / h



PROPULSION

Main engine:	HSD B&W 6S70MC 18,558 kW @ 91 RPM
Propeller type:	Fixed pitch
Generators:	3 diesel generators

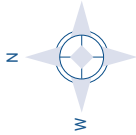

CAPITAL

SHIP MANAGEMENT CORP

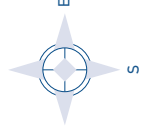
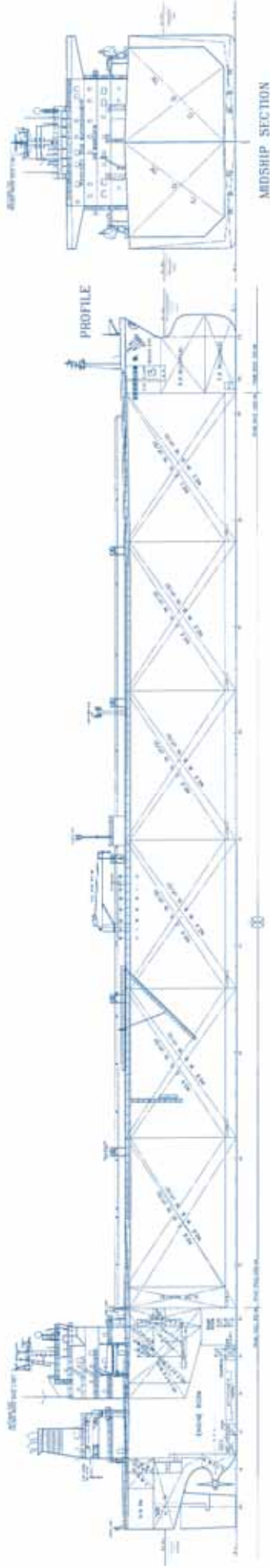

M/T ALTEREGO II M/T AMORE MIO II

3, Iassonos St., Piraeus 185 37, GREECE
Tel: +30 210 4584900, Fax: +30 210 4285679
e-mail: info@capitalship.gr - www.capitalship.gr